

658030 PIN VALVE CLAMP



PIN valve

Drive: Handwheel

Connection: CLAMP normativae DIN 32676 TAB.4 REIHE C e TAB.2 REIHE A

Material: Aisi 316L (1.4404)

Measure: 1/2" and 1"

Operating temperature: -20°C+160°C

Outer finish: Polished

On request:

Antistatic device ATEX II 2 G-D T4 zone 1-21

M.O.C.A. CE 1935/2004

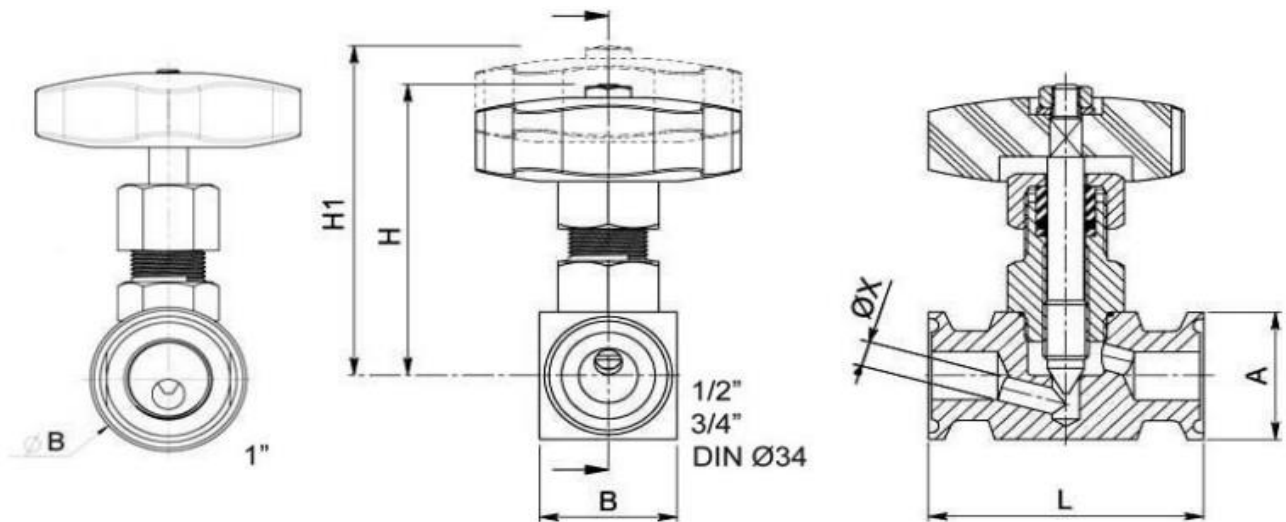

CLAMP	ØA	L	B	H	H1	ØX	PN	kg
1/2"	25	52	25	70	78	5	160	0.300
3/4"	25	70	Ø 35	67	80	6	100	0.430
DIN Ø34	34	70	Ø 35	67	80	6	100	0.478
1"	50.5	90	Ø 52	104	119	10	100	1.230

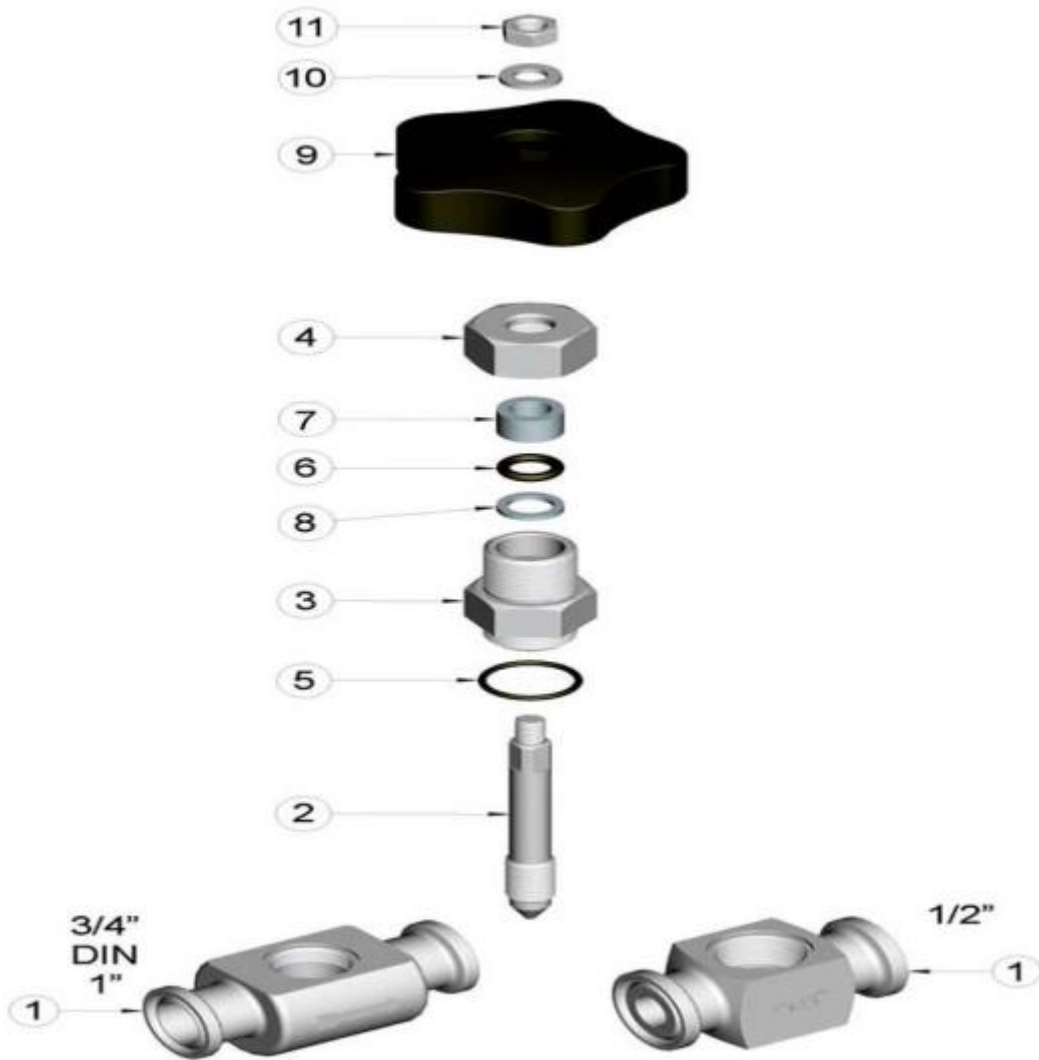

POS.	MATERIAL
1	AISI 316L
2	AISI 316L
3	AISI 316L
4	AISI 316L
5	FKM
6	FKM
7	PTFE Caricato Vetro/With glass
8	PTFE
9	Duroplast
10	AISI 304L
11	AISI 304L