

303030 T FOR DIN PIPE



THREE-way ball valve 4 seals with "T" port
Drive: ISO 5211 – DIN 3337 flange for actuator
Connection: **CLAMP normative DIN 32676 TAB.2 REIHE A**
For TUBE according to normative DIN 11850
Flow: Full and reduced
Material: Aisi 316L (1.4404)
Measure: from DN10 to DN100
Seals: Modified Virgin P.T.F.E.
Operating temperature: -20°C+170°C
Outer finish: Polished

On request:

Antistatic device ATEX II 2 G-D T4 zone 1-21

M.O.C.A. CE 1935/2004

• Seals made of:

PTFE with glass -20°C+170°C

PTFE with carbographite -20°C+180°C

PTFE with inox -20°C+200°C

UHMW High-molecular weight polyethylene -20°C+80°C

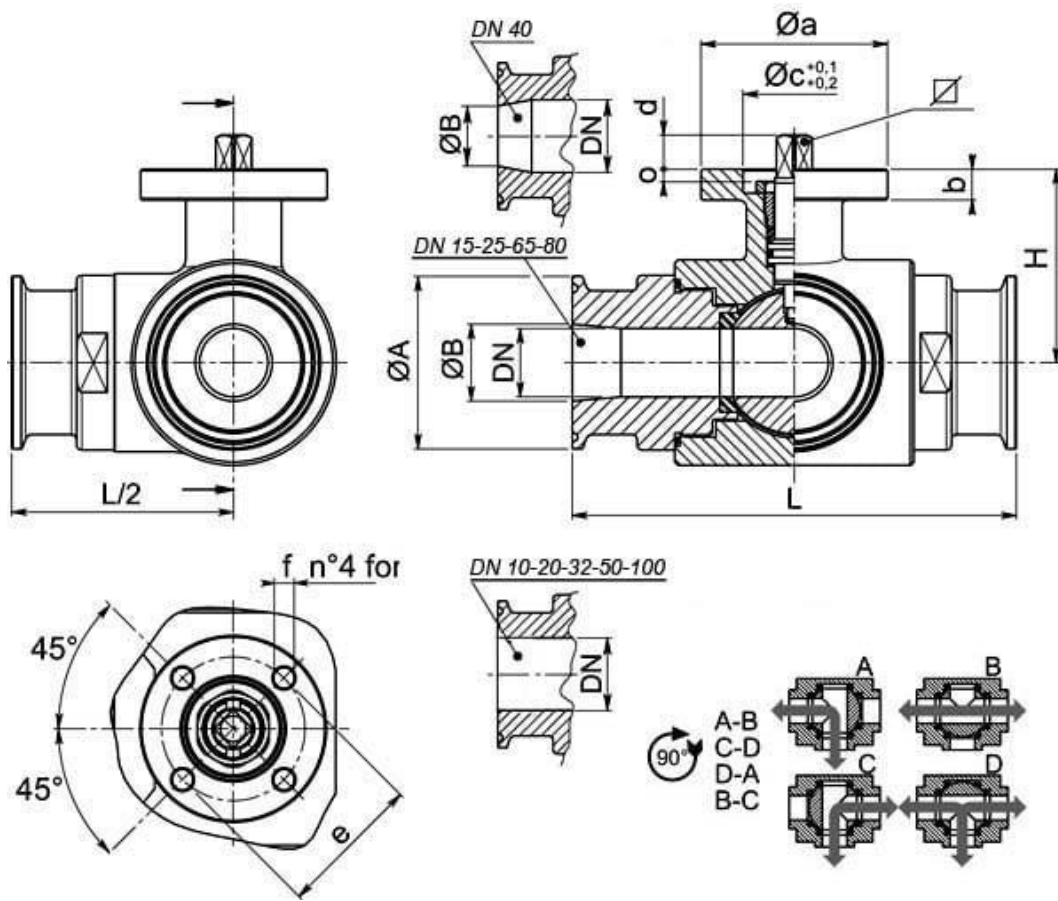

CLAMP REIHE A DN	L	Ø A	Ø B	H	PN	Kg	ISO-DIN	Ø a	Ø c _{xo}	□	d	e	Nm
10	108	34	10	46,5	100	1,06	F.03	46	25x3	9	8	36	10
10	108	34	10	46,5	100	1,10	F.04	54	30x3	11	10	42	10
15	118	34	16	49	100	1,31	F.03	46	25x3	9	8	36	12
15	118	34	16	49	100	1,35	F.04	54	30x3	11	10	42	12
20	130	34	20	56,5	100	2,43	F.04	54	30x3	11	10	42	23
20	130	34	20	56,5	100	2,54	F.05	65	35x3	14	13	50	23
25	140	50,5	26	61	64	3,12	F.04	54	30x3	11	10	42	25
25	140	50,5	26	61	64	3,23	F.05	65	35x3	14	13	50	25
32	156	50,5	32	81,5	64	4,87	F.05	65	35x4	14	13	50	33
32	156	50,5	32	81,5	64	5,03	F.07	90	55x4	17	15	70	33
40	172	50,5	38	89	64	7,25	F.05	65	35x4	14	13	50	40
40	172	50,5	38	89	64	7,42	F.07	90	55x4	17	15	70	40
50	182	64	50	91,5	40	8,65	F.07	90	55x4	17	15	70	50
50	182	64	50	91,5	40	8,82	F.10	125	70x4	22	18	102	50
65	196	91	66	101,5	40	10,65	F.07	90	55x4	17	15	70	60
65	196	91	66	101,5	40	11,15	F.10	125	70x4	22	18	102	60
80	256	106	81	116	40	21,85	F.07	90	55x4	17	15	70	110
80	256	106	81	116	40	22,35	F.10	125	70x4	22	18	102	110
100	286	119	100	131	16	33,80	F.07	90	55x4	17	15	70	130
100	286	119	100	131	16	34,28	F.10	125	70x4	22	18	102	130

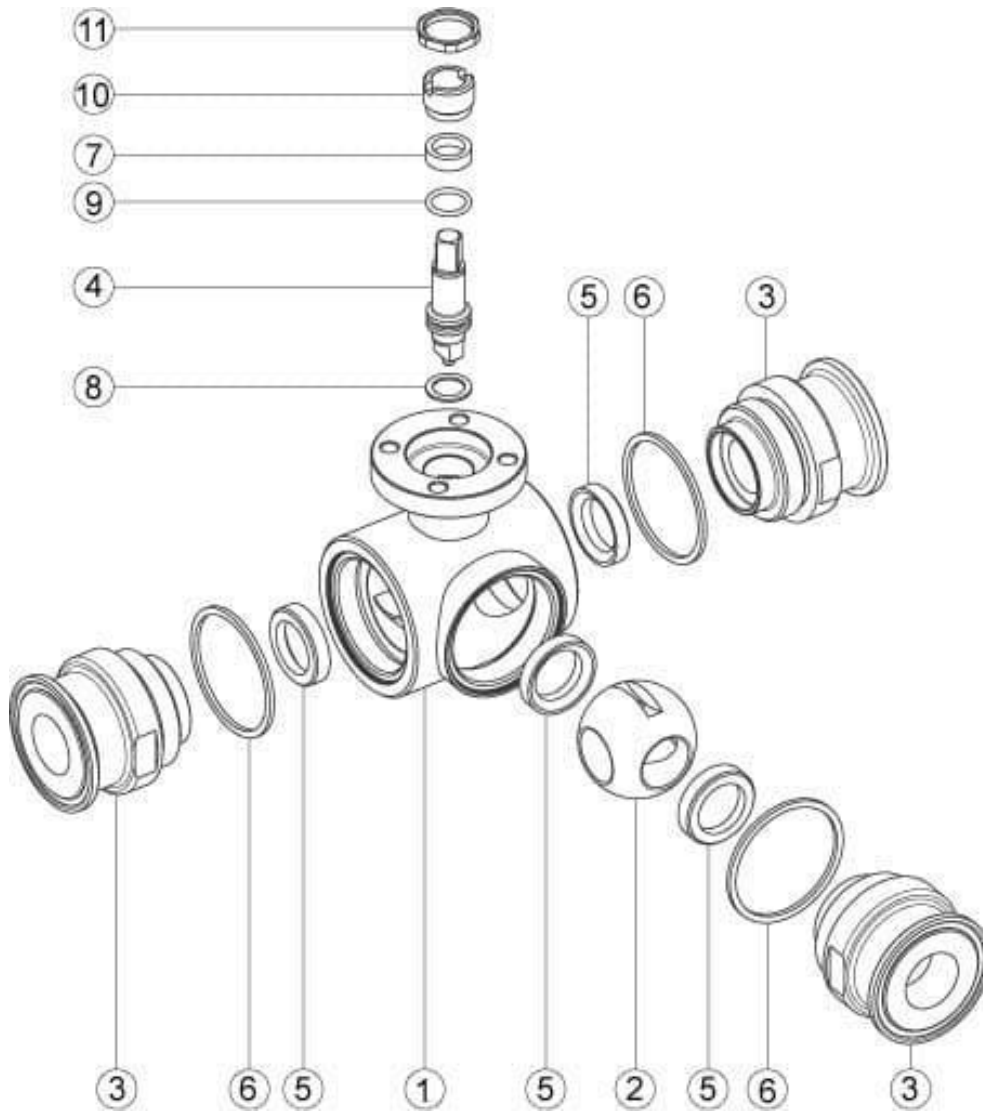

POS.	DENOMINATION	PCS	MAT.
1	Body	1	AISI 316L
2	Ball	1	AISI 316L
3	Sleeves	3	AISI 316L
4	Stem	1	AISI 316L
5	Ball Seals	4	PTFE Vergine Modificato
6	Sleeve Seals	3	PTFE
7	Stem Seal	1	PTFE
8	Stem Seal	1	PTFE
9	Stem or-Seal	1	FKM
10	Register ring	1	AISI 304L (303)
11	Locknut	1	AISI 303

