

303025_T_4 SEALS STANDARD SEALS – F DIN 11851



THREE-way ball valve 4 seals with “T”

Drive: ISO 5211 – DIN 3337 flange for actuator

Connection: DIN 11851 female/female/female

Flow: Full

Material: Aisi 304L (1.4307) – Aisi 316L (1.4404)

Measure: from DN10 to DN100

Seals: Modified Virgin P.T.F.E.

Operating temperature: -20°C+170°C

Outer finish: Polished

On request:

Antistatic device ATEX II 2 G-D T4 zone 1-21

M.O.C.A. CE 1935/2004

• Seals made of:

PTFE with glass -20°C+170°C

PTFE with carbographite -20°C+180°C

PTFE with inox -20°C+200°C

UHMW High-molecular weight polyethylene -20°C+80°C

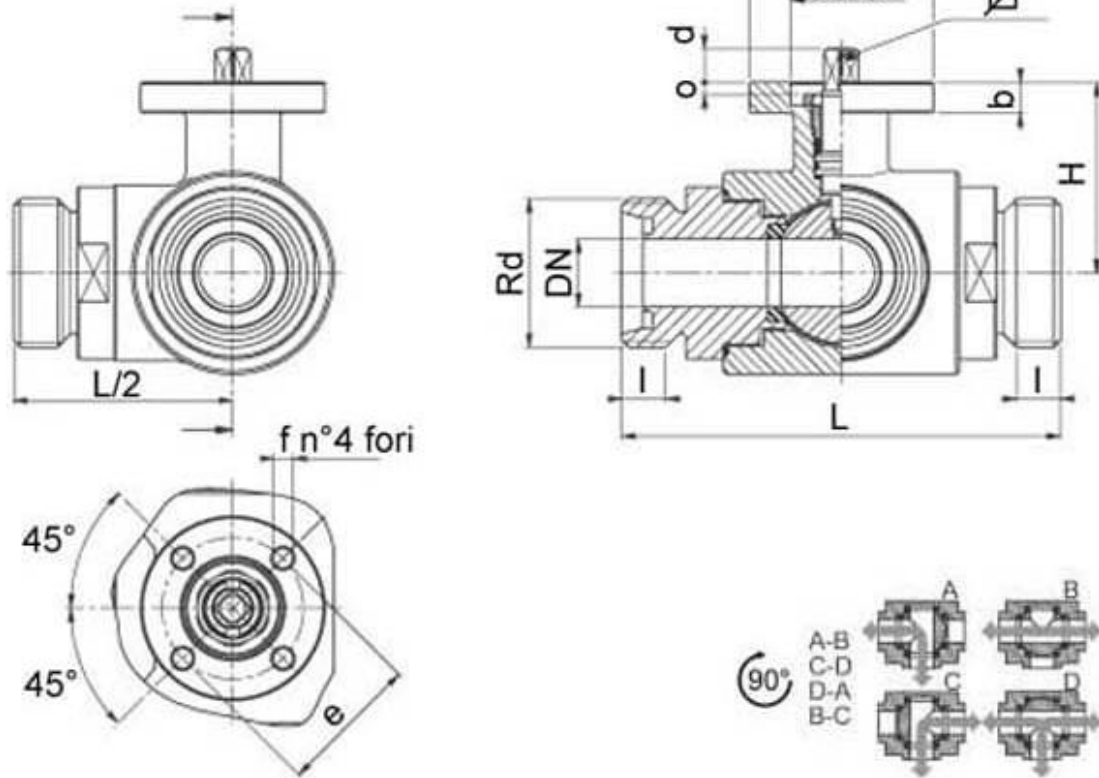

DIN	DN	L	I	H	PN	ISO-DIN	Ø a	b	□	d	e	f	Nm
10	10	108	12	46,5	100	F.03	46	9	9	8	36	6	10
10	10	108	12	46,5	100	F.04	54	9	11	10	42	6	10
15	15	118	12	49	100	F.03	46	9	9	8	36	6	12
15	15	118	12	49	100	F.04	54	9	11	10	42	6	12
20	20	130	14	56,5	100	F.04	54	9	11	10	42	6	23
20	20	130	14	56,5	100	F.05	65	9	14	13	50	7	23
25	25	140	14	61	64	F.04	54	9	11	10	42	6	25
25	25	140	14	61	64	F.05	65	9	14	13	50	7	25
32	32	156	14	81,5	64	F.05	65	9	14	13	50	7	33
32	32	156	14	81,5	64	F.07	90	12	17	15	70	9	33
40	40	172	14	89	64	F.05	65	12	14	13	50	7	40
40	40	172	14	89	64	F.07	90	12	17	15	70	9	40
50	50	182	14	91,5	40	F.07	90	12	17	15	70	9	50
50	50	182	14	91,5	40	F.10	125	12	22	18	102	11	50
65	65	196	16	101,5	40	F.07	90	12	17	15	70	9	60
65	65	196	16	101,5	40	F.10	125	12	22	18	102	11	60
80	80	256	20	116	40	F.07	90	12	17	15	70	9	110
80	80	256	20	116	40	F.10	125	12	22	18	102	11	110
100	100	286	20	131	16	F.07	90	12	17	15	70	9	130
100	100	286	20	131	16	F.10	125	12	22	18	102	11	130
125	(Reduced) 100	286	25	131	16	F.07	90	12	17	15	70	9	130
125	(Reduced) 100	286	25	131	16	F.10	125	12	22	18	102	11	130

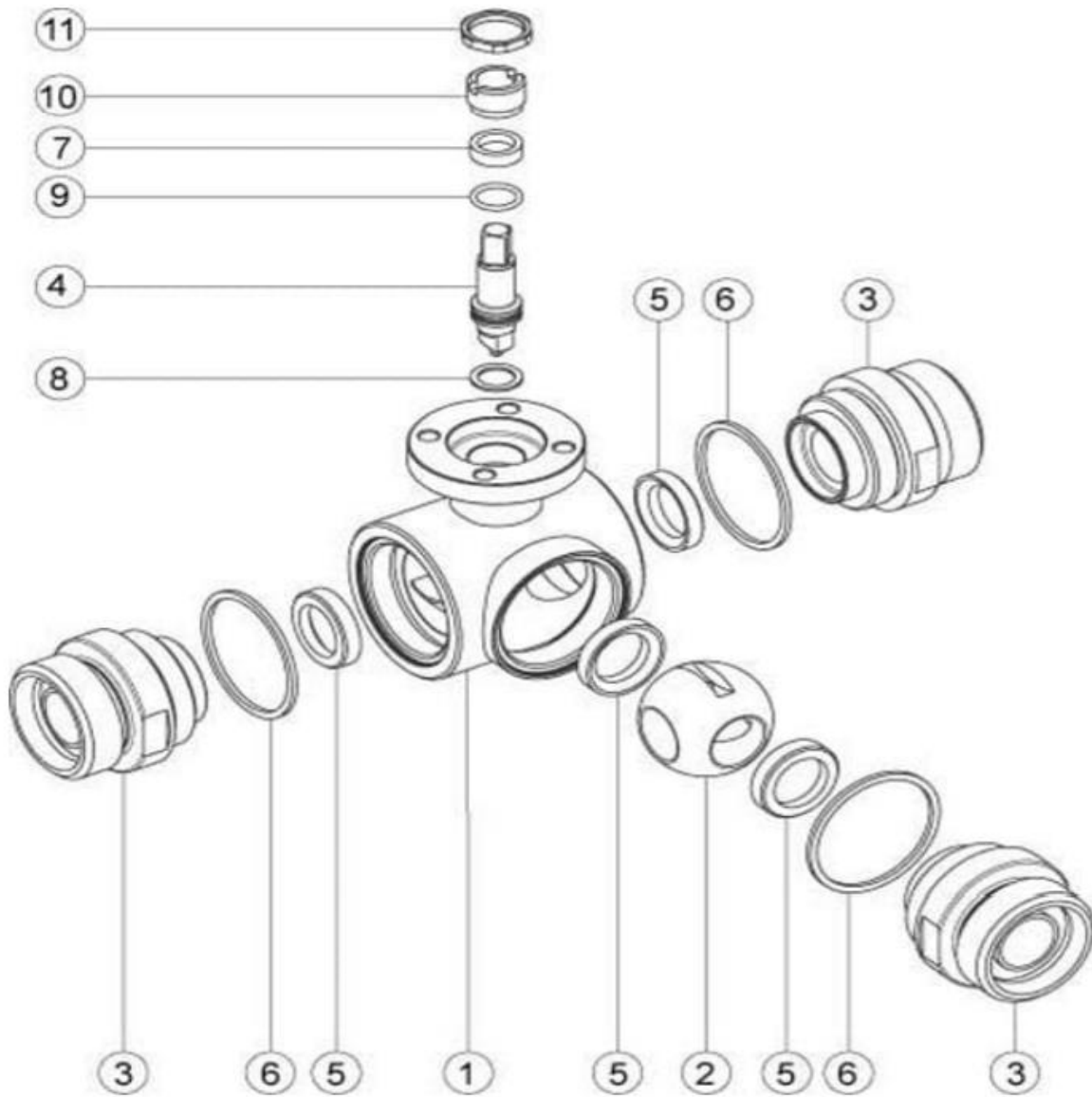

POS.	DENOMINATION	PCS	MATERIAL
1	Body	1	AISI 304L - 316L
2	Ball	1	AISI 304L - 316L
3	Sleeves	3	AISI 304L - 316L
4	Stem	1	AISI 304L - 316L
5	Ball Seals	4	PTFE
6	Sleeve Seals	3	PTFE
7	Stem Seal	1	PTFE
8	Stem Seal	1	PTFE
9	Stem or-Seal	1	FKM
10	Register ring	1	AISI 304L (303)
11	Locknut	1	AISI 303

